2014 *C. elegans* Development, Cell Biology & Gene Expression

Meeting

in association with

The 6th Asia-Pacific *C. elegans* Meeting

Tuesday, July 15, 2014 – Saturday, July 19, 2014

Meeting Organizers

Asako Sugimoto, Tohoku U. (Japan)
Andrew Chisholm, U. California-San Diego (USA)
Ahna Skop, U. Wisconsin-Madison (USA)

Scientific Organizing Committee

Chang-She Chen, National Cheng-Kung U. (Taiwan)
King Chow, The Hong Kong U. (Hong Kong)
Alex Hajnal, U. Zurich (Switzerland)
E. Jane Hubbard (USA)
Takeshi Ishihara, Kyushu U. (Japan)
Seung-Jae Lee, POSTECH (South Korea)
Massimo Hilliard, New York U. (USA)
Kiyoji Nishiwaki, Kwansei Gakuin U. (Japan)
Mi Hye Song, Oakland U. (USA)
Anne Spang, Biozentrum (Switzerland)
Sander van den Heuvel, Utrecht U. (The Netherlands)
Ronen Zaidel-Bar, National U. of Singapore (Singapore)

Local Organizing Committee

Ken Sato, Gunma U. (Japan)
Kotaro Kimura, Osaka U. (Japan)
Shuichi Onami, RIKEN (Japan)
Masahiro Ito, Ritsumeikan U. (Japan)

Acknowledgement of Sponsorship

The organizing committee gratefully acknowledges the generous financial support of the following organizations.

Grants

The Molecular Biology Society of Japan
(日本分子生物学会)



The Uehara Memorial Foundation
(上原記念生命科学財団)

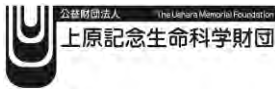

The Company of Biologists



Inoue Foundation for Science
(井上科学振興財団)

The Japan World Exposition 1970
Commemorative Fund
(日本万国博覧会記念基金)



NOVARTIS Foundation (Japan)
(ノバルティス科学振興財団)



Society for Developmental Biology



Nara Visitors Bureau
(奈良県ビジットーズビューロー)



National Institute of Genetics
(国立遺伝学研究所)



Acknowledgement of Sponsorship

Sponsor, Donation, Advertisement and Exhibition

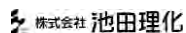

Program at a Glance

Tuesday, July 15	Wednesday, July 16	Thursday, July 17	Friday, July 18	Saturday, July 19
	<p>9:00</p> <p>Session 2 Germline, Cell division, Cell Polarity Chairs: S. van den Heuvel, E. J. Hubbard Keynote Speaker: Abby Dernborg</p> <p>12:15</p> <p>Lunch (Yume-Kaze Plaza)</p> <p>14:00</p> <p>Session 3 Developmental Timing, Cell Fate, Gene Expression Chairs: K. Nishiwaki, A. Hajnal Keynote Speaker: Hitoshi Sawa</p> <p>17:30</p> <p>Dinner (with poster viewing)</p> <p>19:00</p> <p>Poster Session I Presentation of ODD-numbered posters</p> <p>21:00</p> <p>Beer Time (Yume-Kaze Plaza)</p> <p>22:30</p>	<p>9:00</p> <p>Session 4 Neurobiology Chairs: A. van der Linden, T. Ishihara Keynote Speaker: Sandhya Koushika</p> <p>12:15</p> <p>Lunch (Yume-Kaze Plaza)</p> <p>14:00</p> <p>Free Time (Optional: Walking Excursion)</p> <p>17:30</p> <p>Dinner (with poster viewing)</p> <p>19:00</p> <p>Poster Session II Presentation of EVEN-numbered posters</p> <p>21:00</p> <p>Beer Time (Yume-Kaze Plaza)</p> <p>22:30</p>	<p>9:00</p> <p>Session 5 Cell Death, Organelles Chairs: K. Sato, A. Spang Keynote Speaker: Xiaochen Wang</p> <p>12:15</p> <p>Lunch (Yume-Kaze Plaza)</p> <p>14:00</p> <p>Session 6 [NIG Research Meeting] Morphogenesis, Cytoskeleton Chairs: M.H. Song, K. Chow Keynote Speaker: Michel Labrousse</p> <p>16:30</p> <p>Special Keynote Masatoshi Takeichi</p> <p>17:30</p> <p>Visit to Nara National Museum [Nara Buddhist Sculpture Hall] 19:00</p> <p>Welcome Drink</p> <p>19:30</p> <p>Barquet (Museum Restaurant "Half Time")</p> <p>21:30</p> <p>22:00</p> <p>(Optional: Japanese Pub)</p>	<p>9:00</p> <p>Session 7 Aging, Stress, Metabolism, Pathogenesis Chairs: S.-J. Lee, C.-L. Pan Keynote Speaker: Yuji Kohara</p> <p>12:00</p>
<p>14:00</p> <p>Registration</p> <p>15:50</p> <p>Session 1 Systems and Quantitative Biology Chairs: Z. Bao, R. Zaidel-Bar Keynote Speakers: Zhirong Bao Bruce Bowerman</p> <p>19:05</p> <p>Welcome Mixer (at the garden of Public Hall)</p> <p>21:00</p>				

Area Map and Ground Transportation

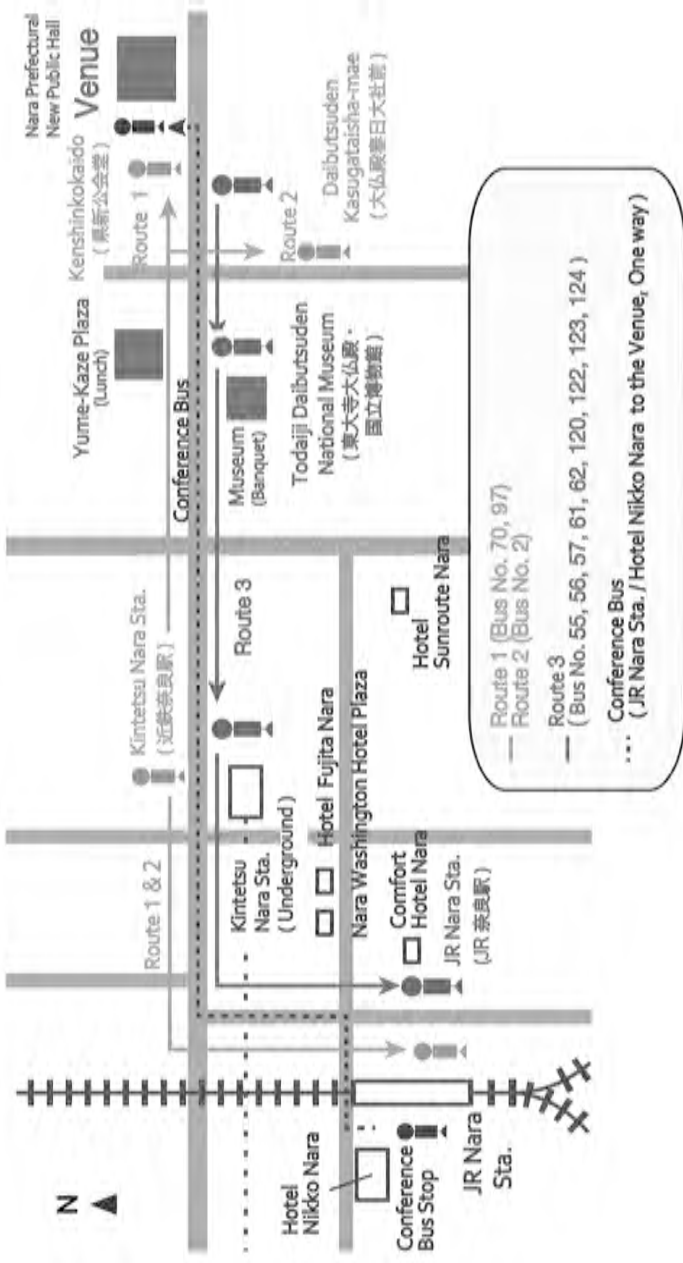

Public Buses

Local buses are frequently served (JPY 210).

From JR Nara Station/Kintetsu Nara Station to the Venue

- **Route 1: Bus No.70, 97**
JR Nara Station (JR 奈良駅) -(5 min.)-
Kintetsu Nara Station (近鉄奈良駅) -(8 min.)-
Kenshinkokaido (県新公会堂)
- **Route 2: Bus No. 2**
JR Nara Station (JR 奈良駅) -(5 min.)-
Kintetsu Nara Station (近鉄奈良駅) -(8 min.)-
Daibutsuden Kasugataisha-mae (大仏殿春日大社前)

Bus Schedule

Route 1: Bus No. 70 (Kasugataisha-Honden 春日大社本殿)

The nearest bus stop to the venue: "Kenshinkokaido 県新公会堂"

(~13 min. from JR Nara Sta.)

Mon. - Fri.	JR Nara Sta. (JR奈良駅)	Kintetsu Nara Sta. (近鉄奈良駅)	Sat.	JR Nara Sta. (JR奈良駅)	Kintetsu Nara Sta. (近鉄奈良駅)
7	16 43 57	20 47	7	19	22
8	23	1 27	8	4 22	8 26
9	4 38 59	8 42	9	6 38 59	10 42
10	29 59	3 33	10	29 59	3 33
11	29 59	3 33	11	29 59	3 33
12	29 59	3 33	12	29 59	3 33
13	29 59	3 33	13	29 59	3 33
14	29 59	3 33	14	29 59	3 33
15	29 59	3 33	15	29 59	3 33
16	30 59	3 34	16	29 59	3 33
17		3	17		3

Route 2: Bus No. 2 (Shinaijunkan-Soto 市内循環・外)

The nearest bus stop to the venue: "Daibutsuden Kasugataisha-mae 大仏殿春日大社前"

(~13 min. from JR Nara Sta.)

Mon. - Fri.	JR Nara Sta. (JR奈良駅)	Kintetsu Nara Sta. (近鉄奈良駅)	Sat.	JR Nara Sta. (JR奈良駅)	Kintetsu Nara Sta. (近鉄奈良駅)
5	44 55	48 59	5	47	51
6	6 17 30 41 48 56	10 21 35 46 53	6	4 9 26 32 42 49 55	8 13 30 36 46 53 59
7	6 11 15 25 35 40 45 55	1 11 16 20 30 40 45 50	7	5 12 19 29 37 43 53	9 16 23 33 42 48 58
8	5 10 15 25 35 40 45 55	0 10 15 20 30 40 44 50	8	3 9 19 29 36 46 56	8 14 24 34 41 51
9 - 17	5 15 25 35 45 55	1 11 21 31 41 51	9 - 17	5 15 25 35 45 55	1 11 21 31 41 51
18	5 15 25 35 45 55	0 10 20 30 40 50	18	5 15 25 35 45 55	0 10 20 30 40 50
19	5 15 25 33 43 51 58	0 10 20 30 38 48 56	19	5 15 25 33 43 51 58	0 10 20 30 38 48 56
20	8 16 23 33 40 47 57	0 10 20 27 37 44 51	20	8 16 24 33 40 49 57	3 12 20 28 37 44 53
21	4 11 20 27 34 44 57	1 8 15 25 30 38 48	21	4 13 20 36 43 59	1 7 17 24 40 47 53
22	7 20 30 43 53	1 11 24 34 47 57	22	6 29 52	2 10 33 56
23	6 16 29 39	10 20 33 43	23	15 38	19 41
24	9 23				

From the Venue to JR Nara Station/Kintetsu Nara Station

- **Route 1: Bus No.70, 97**
Kenshinkokaido (県新公会堂)-(8 min.)-
Kintetsu Nara Station (近鉄奈良駅)-(5 min.)-
JR Nara Station (JR 奈良駅)
- **Route 3: Bus No. 55, 56, 57, 59, 61, 62, 120, 122, 123, 124**
Daibutsuden Kasugataisha-mae (大仏殿春日大社前)-(8 min.)-
Kintetsu Nara Station (近鉄奈良駅)-(5 min.)-
JR Nara Station (JR 奈良駅)

Bus Schedule

Route 1: Bus No. 70 (Rokujosan 六条山) , No. 97 (Horyuji-mae 法隆寺前)

Departing from “Kenshinkokaido (県新公会堂)” Bus stop

Mon. - Fri.	Kenshinkokaido 県新公会堂
10	17 37 47
11	17 37 47
12	17 37 47
13	17 37 47
14	17 37 47
15	17 37 47
16	21 37 47
17	22

Sat.	Kenshinkokaido 県新公会堂
10	17 37 47
11	17 37 47
12	17 37 47
13	17 37 47
14	17 37 47
15	17 37 47
16	17 37 51
17	22

Route 3: Bus No. 1, 55, 56, 57, 59, 61, 62, 120, 122, 123, 124

Departing from Todaiji-Daibutsuden, National Museum (東大寺大仏殿・国立博物館)

Mon. - Fri.	Todaiji-daibutsuden, National Museum 東大寺大仏殿、国立博物館
10 - 18	Every 5 min.
19	5 8 15 18 26 28 36 37 46 50 53
20	3 4 13 17 20 30 32 40 46 53 56
21	3 5 10 20 27 33 43 46 54
22	4 6 27 34 52
23	9 19

Sat.	Todaiji-daibutsuden, National Museum 東大寺大仏殿、国立博物館
10 - 18	Every 5 min.
19	2 8 10 18 26 36 37 46 52 54
20	0 4 11 17 22 27 32 48 53
21	12 27 35 43 58
22	6 18 36
23	

Conference Buses

We will provide Conference Buses (free) from Hotel Nikko Nara/JR Nara Station (West Exit) to the Venue with the following schedule.

July 15: 13:45, 14:30, 15:15

July 16 - 19: 8:10, 8:40

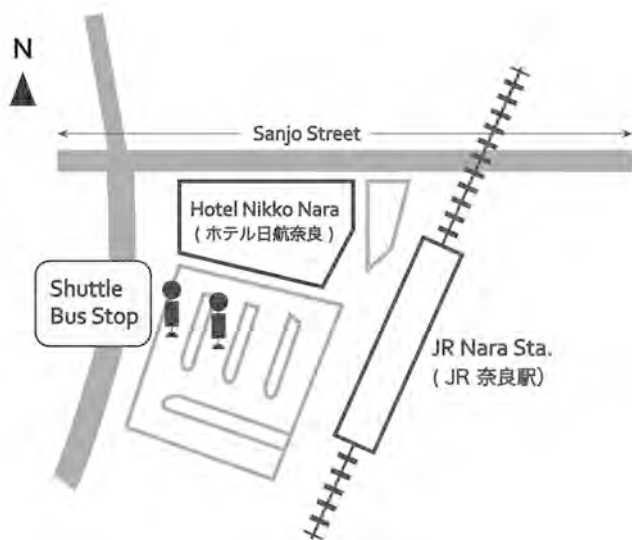

Taxi

Yamato Kotsu (大和交通) 0742-22-7171

Ikoma Kotsu (生駒交通) 0743-73-3131

Nara Kintetsu Taxi (奈良近鉄タクシー) 0742-22-5501

(Operator may not speak English: seek help at the registration desk)

Floor Map

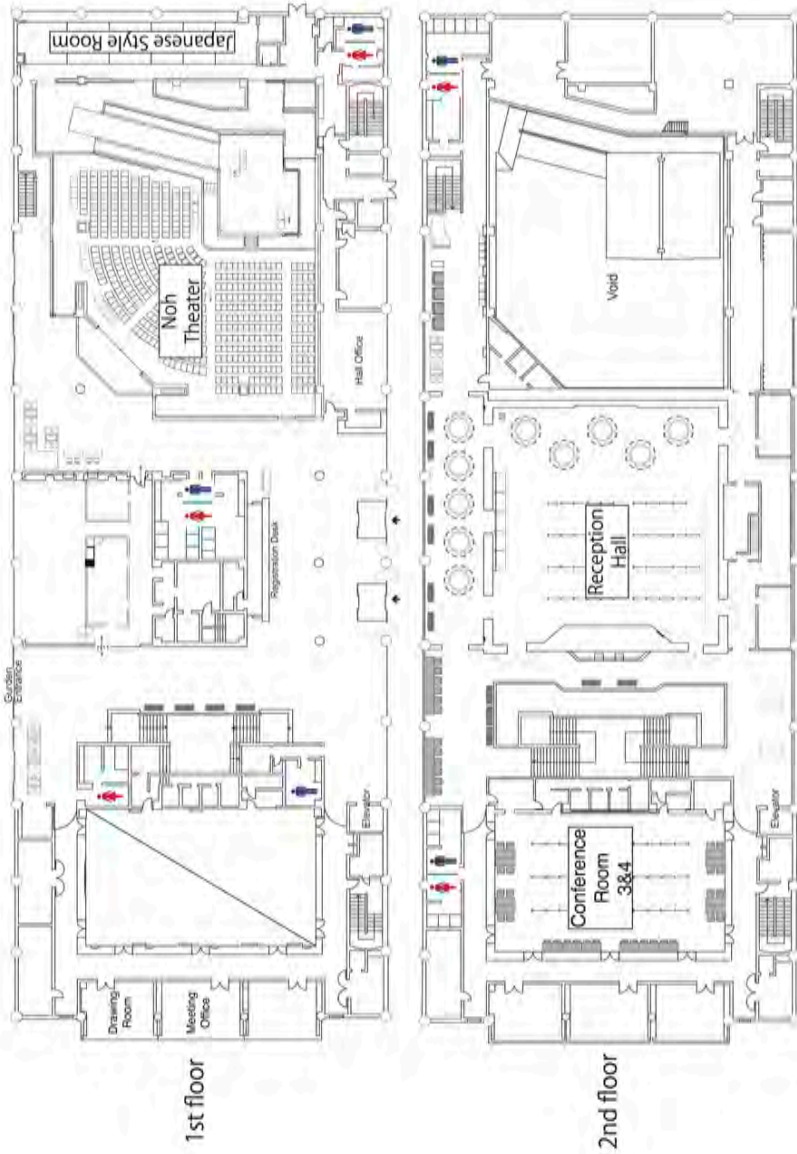

Reception Hall (Poster #67 - #141)

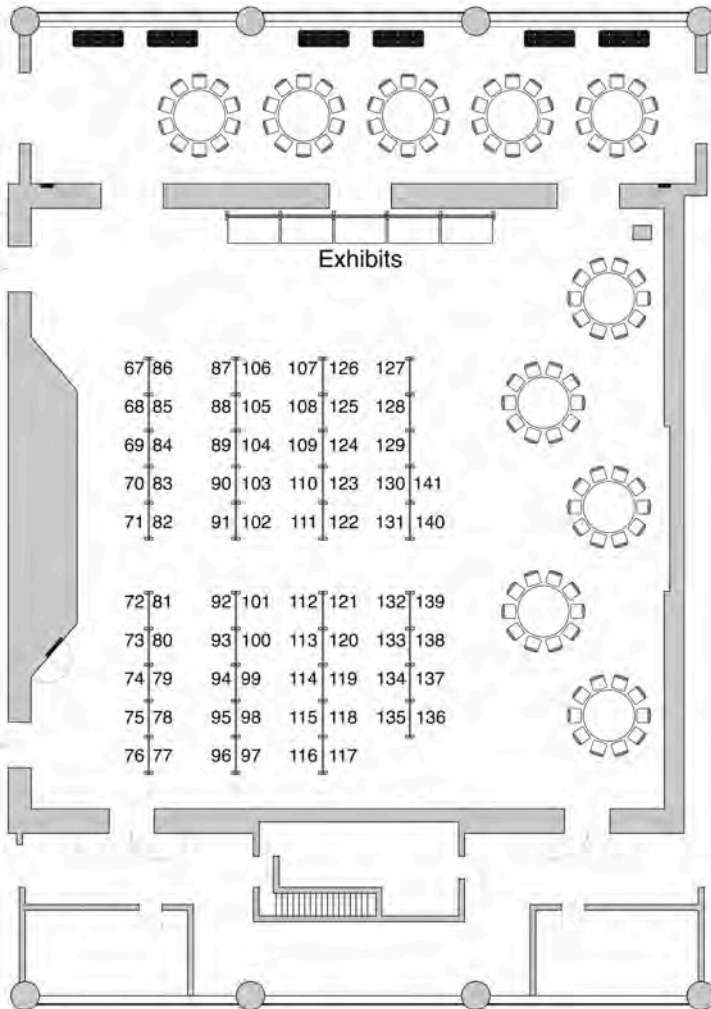

Conference Room 3&4 (Poster #142 - #200)

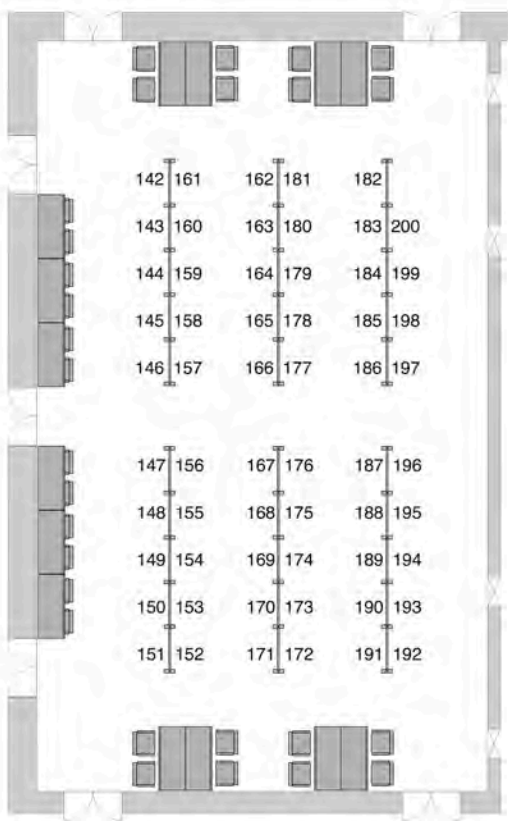

General Information

Venue

Nara Prefectural New Public Hall
101 Kasugano-machi, Nara City
TEL: 0742-27-2630

Registration

Reception desk at Nara Prefectural New Public Hall.

July 15	14:00-19:00
July 16-18	8:30-17:00
July 19	8:30-12:00

On-site Registration is available.

Meals

Registration fee includes:

Welcome Mixer (July 15)

Lunch (July 16, 17, 18)

Meal Coupons for restaurants at Yume-Kaze Plaza (5 min. walk from the New Public Hall) are included in the registration package.

Dinner (July 16, 17)

Dinner will be served in the poster area (2nd floor) and in the Japanese Style Room (1st floor).

Banquet (July 18)

Banquet will be held at "Half Time" restaurant at Nara National Museum (5 min walk).

Parking

There is no parking space at the New Public Hall. Please use public transportation.

Internet

Free WiFi is available throughout the New Public Hall.

Cameras, Cell Phones and Video Recording Devices

In order to protect unpublished data, the use of cameras and other recording devices in platform and poster sessions is prohibited.

Lunch Map



- | | |
|--|--|
| ① Ban-INOUE
 W, J, V (40 seats) | ⑤ Naraya
 J (45 seats) |
| ② Kurokawa Honke
 W, J (50 seats) | ⑥ Tenpyo-an
 J (30 seats) |
| ③ Warabe Yorokobi An
 J, V (30 seats) | ⑦ TEN. TEN. Cafe
W (34 seats) |
| ④ Cafe i-lunga
 W, V (12 seats) | ⑧ Izasa
 J (60 seats) |

W : Western J : Japanese V : Vegetarian food available

Presentation Instructions

(Program # = Abstract Book Page #)

Platform sessions

All platform sessions are held in the Noh Theater in Nara Prefectural New Public Hall. To preserve the special wooden stage made for the traditional Noh drama, PLEASE TAKE OFF YOUR SHOES when you get on the stage. Eating and drinking are prohibited in the Noh Theater, except water for speakers and chairs.

Instruction for speakers:

Time allocation:

Special Keynote Talk: 50 min. Presentation + 10 min. Discussion (total 60 min.)

Keynote Talk: 35 min. Presentation + 5 min. Discussion (total 40 min.)

Oral Presentation: 12 min. Presentation + 3 min. Discussion (total 15 min.)

Audio-Visual Equipment:

- The Noh Theater will have Mac and Windows computers and an LCD projector.
- Presenters must arrive 30 minutes prior to the start of their session. All speakers should bring presentation files saved on an USB Flash Memory Drive. Please name your presentation file "Program#_Last Name" (for example, "99_Brenner"). Presentations will be copied to the computer provided prior to your session.
- Our computers are loaded with the following applications.
Mac: PowerPoint for Mac 2011, Keynote '09 (ver.5) and Keynote 6.
Windows7: PowerPoint 2010
- If you need to use your own computer because of incompatibilities with the above settings, please ensure that your computer is equipped with the proper monitor connector (mini D-sub 15 pin) or bring an appropriate converter with you. Please turn off screen saver and energy saving features of your PC monitor ahead of time, and bring your own AC adapter.

Poster Sessions

- Poster session will be held in Reception Hall (Poster# 67 -141) and Conference Room 3/4 (Poster# 142-200).
- Poster board size: 180 cm (70.9 inch) High x 120 cm (47.2 inch) Wide.
- Pushpins will be provided for your use.
- All posters may be mounted beginning at 14:00 on Wednesday, July 16, and must be removed by 17:00 on Friday, July 18.
- Authors are expected to present at their posters for one time slot, according to the following schedule:
 - July 16 19:00-21:00: Poster Session I, ODD-numbered posters
 - July 17 19:00-21:00: Poster Session II, EVEN-numbered posters